

### Technical data

Steel body pressure rating 350 bar	Cavity T11A	Steel body weight 1.0 kg
---------------------------------------	----------------	-----------------------------

### Body material X

X	Material, coating
S	steel, black-oxide
S3	steel, zinc

### Port size Y

Y	Ports 1,2	Port 3
1	3/8" BSP	1/4" BSP

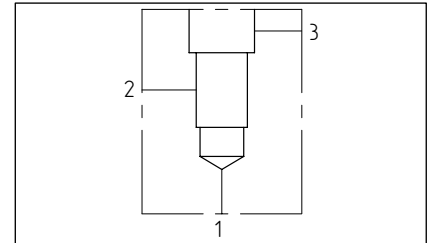

### Dimensions

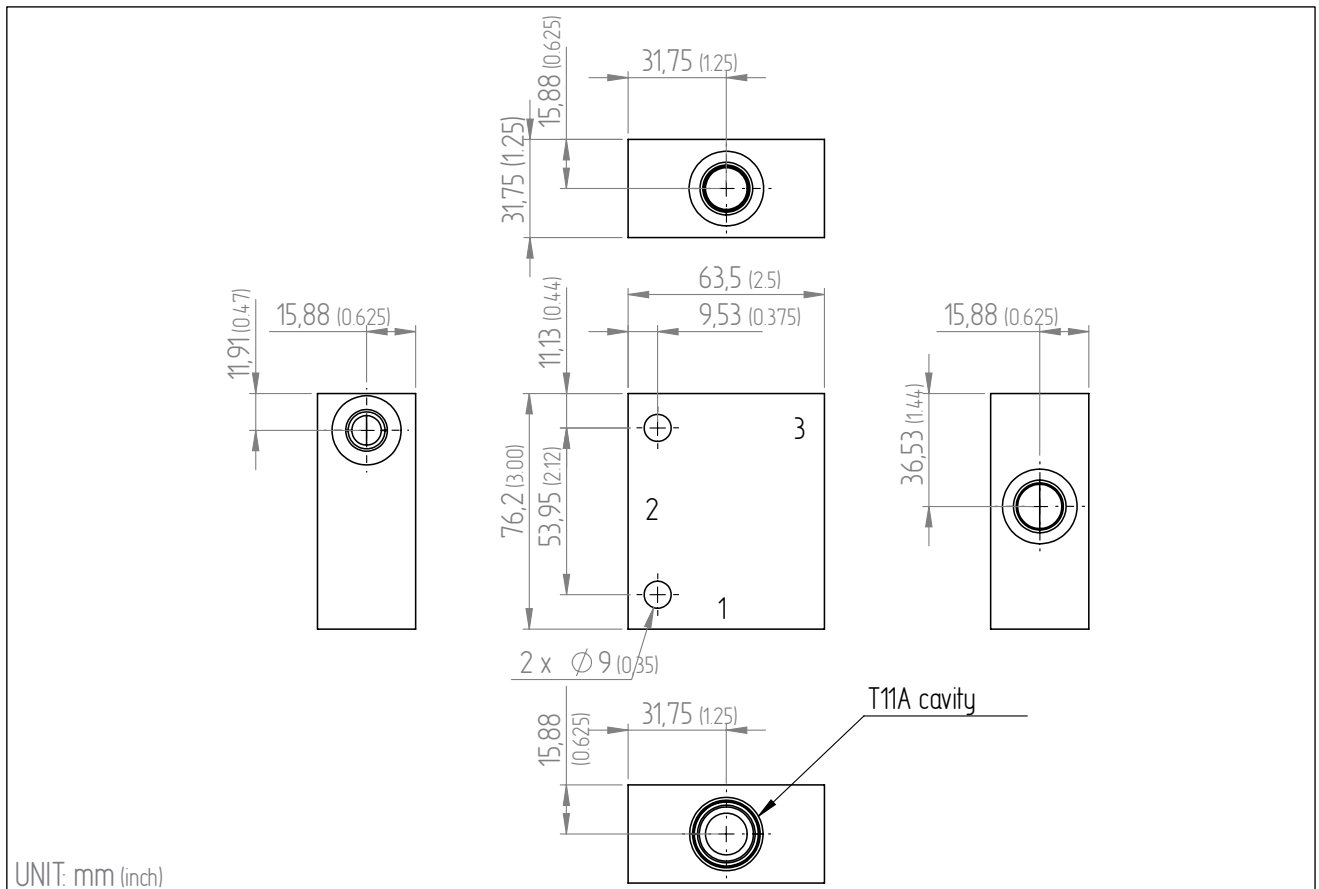

### Cartridge valve selection Z\*

Z	Valve code	Description	Hydraulic symbol	Data
	body only			
11	DW2A-T11A-MAN-DG12	Solenoid-operated,		12 VDC 24 VDC
12	DW2A-T11A-MAN-DG24	2/3, poppet valve (30 l/min, 0.51 kg)		
21	RV2A-T11A-LAN	Pilot operated relief valve with vent (60 l/min, 0.17 kg)		7-210 bar
22	RV2A-T11A-LBN			3.5-105 bar
23	RV2A-T11A-LCN			10.5-420 bar
24	RV2A-T11A-LNN			5-55 bar

\*Z is not marked on the body

Ordering code: 2003.0541.X.Y.Z

## Cartridge valve selection (cont.) Z\*

Z	Valve code	Description	Hydraulic symbol	Data
31	RS2C-T11A-LAN	Pilot operated sequence valve (60 l/min, 0.17 kg)		7-210 bar
32	RS2C-T11A-LBN			3.5-105 bar
33	RS2C-T11A-LCN			10.5-400 bar
34	RS2C-T11A-LEN			1.7-28 bar
35	RS2C-T11A-LNN			5-55 bar
41	SQ2B-T11A-LAN	Kick-down, pilot operated, balanced piston sequence valve (60 l/min, 0.17 kg)		7-210 bar
42	SQ2B-T11A-LBN			3.5-105 bar
43	SQ2B-T11A-LCN			10.5-400 bar
44	SQ2B-T11A-LNN			5-55 bar
51	SC2A-T11A-LAN	Direct acting sequence valve with reverse flow check (60 l/min, 0.20 kg)		35-210 bar
52	SC2A-T11A-LBN			20-105 bar
53	SC2A-T11A-LCN			140-420 bar
54	SC2A-T11A-LDN			14-55 bar
55	SX2A-T11A-LAN	Direct acting sequence valve without reverse flow check (60 l/min, 0.20 kg)		35-210 bar
56	SX2A-T11A-LBN			20-105 bar
57	SX2A-T11A-LCN			140-420 bar
58	SX2A-T11A-LDN			14-55 bar
61	PB2B-T11A-LAN	Pilot operated reducing valve (40 l/min, 0.17 kg)		7-210 bar
62	PB2B-T11A-LBN			3.5-105 bar
63	PB2B-T11A-LCN			10.5-420 bar
64	PB2B-T11A-LNN			5-55 bar
71	PP2B-T11A-LAN	Pilot operated pressure reducing / relieving valve (40 l/min, 0.17)		7-210 bar
72	PP2B-T11A-LBN			3.5-105 bar
73	PP2B-T11A-LCN			10.5-420 bar
74	PP2B-T11A-LNN			5-55 bar
75	PR2B-T11A-LAN	Direct acting pressure reducing / relieving valve (40 l/min, 0.20)		7-210 bar
76	PR2B-T11A-LBN			3.5-105 bar
77	PR2B-T11A-LDN			14-55 bar
78	PR2B-T11A-LWN			50-315 bar
81	LR2A-T11A-XDN	Normally closed, modulating element with pilot (60 l/min, 0.12 kg)		3.5 bar
82	LR2A-T11A-XFN			7.0 bar
83	LR2A-T11A-XGN			10.0 bar
91	LR2C-T11A-XDN	Normally closed, modulating element (60 l/min, 0.12 kg)		3.5 bar
92	LR2C-T11A-XFN			7.0 bar
93	LR2C-T11A-XGN			10.0 bar
A1	CK2A-T11A-XAN	Pilot to open check valve with standard pilot & POM seat (3:1, 60 l/min, 0.13 kg)		0.3 bar
A2	CK2A-T11A-XCN			2.0 bar
A3	CK2A-T11A-XEN			5.0 bar
A4	CK2B-T11A-XAN	Pilot to open check valve with standard pilot (3:1, 60 l/min, 0.10 kg)		0.3 bar
A5	CK2B-T11A-XCN			2.0 bar
A6	CK2B-T11A-XEN			5.0 bar
A7	CK2C-T11A-XAN	Pilot to open check valve with sealed pilot & POM seat (3:1, 60 l/min, 0.13 kg)		0.3 bar
A8	CK2C-T11A-XCN			2.0 bar
A9	CK2C-T11A-XEN			5.0 bar
B1	CK2D-T11A-XAN	Pilot to open check valve with sealed pilot (3:1, 60 l/min, 0.13 kg)		0.3 bar
B2	CK2D-T11A-XCN			2.0 bar
B3	CK2D-T11A-XEN			5.0 bar
B4	CK2F-T11A-XAN	Vented, pilot to open check valve with external pilot (3:1, 60 l/min, 0.13 kg)		0.3 bar
B5	CK2F-T11A-XCN			2.0 bar
B6	CK2F-T11A-XEN			5.0 bar

\*Z is not marked on the body

Ordering code: 2003.0541.X.Y.Z

## Cartridge valve selection (cont.) Z\*

Z	Valve code	Description	Hydraulic symbol	Data
C1	CS2D-T11A-XXN	Shuttle valve, signal at port 2 (10 l/min, 0.12 kg)		
C2	CS2B-T11A-XXN	Shuttle valve, signal at port 3 (10 l/min, 0.12 kg)		
B1 B2	CA2A-T11A-LHN CA2A-T11A-LIN	Vented counterbalance valve - atmospherically referenced (3:1, 60 l/min, 0.20 kg)		70-280 bar (210 bar initially setting) 25-105 bar (70 bar initially setting)
B3 B4	CA2G-T11A-LGN CA2G-T11A-LFN	Vented counterbalance valve - atmospherically referenced (5:1, 60 l/min, 0.20 kg)		140-420 bar (280 bar initially setting) 70-175 bar (140 bar initially setting)
C1 C2 C3 C4	CB2A-T11A-LHN CB2A-T11A-LIN CB2A-T11A-LAN CB2A-T11A-LBN	Counterbalance external pilot non-vented valve (3:1, 60 l/min, 0.17 kg)		70-280 bar (w1.7bar check, 210bar) 25-105 bar (w1.7bar check, 70bar) 70-280 bar (w0.3bar check, 210bar) 25-105 bar (w0.3bar check, 70bar)
C5 C6 C7 C8	CB2G-T11A-LJN CB2G-T11A-LKN CB2G-T11A-LCN CB2G-T11A-LDN	Counterbalance external pilot non-vented valve (4.5:1, 60 l/min, 0.17 kg)		140-350 bar (w1.7bar check, 210bar) 70-175 bar (w1.7bar check, 140bar) 140-350 bar (w0.3bar check, 210bar) 70-175 bar (w0.3bar check, 140bar)
D1 D2 D3 D4	CB2H-T11A-LJN CB2H-T11A-LKN CB2H-T11A-LCN CB2H-T11A-LDN	Counterbalance external pilot non-vented valve (10:1, 60 l/min, 0.17 kg)		140-350 bar (w1.7bar check, 210bar) 70-175 bar (w1.7bar check, 140bar) 140-350 bar (w0.3bar check, 210bar) 70-175 bar (w0.3bar check, 140bar)
D5 D6 D7 D8	CB2C-T11A-LHN CB2C-T11A-LIN CB2C-T11A-LAN CB2C-T11A-LBN	Semi-restrictive counterbalance valve (3:1, 40 l/min, 0.17 kg)		70-280 bar (w1.7bar check, 210bar) 25-105 bar (w1.7bar check, 70bar) 70-280 bar (w0.3bar check, 210bar) 25-105 bar (w0.3bar check, 70bar)
E1 E2 E3 E4	CB2D-T11A-LJN CB2D-T11A-LKN CB2D-T11A-LCN CB2D-T11A-LDN	Semi-restrictive counterbalance valve (4.5:1, 40 l/min, 0.17 kg)		140-350 bar (w1.7bar check, 210bar) 70-175 bar (w1.7bar check, 140bar) 140-350 bar (w0.3bar check, 210bar) 70-175 bar (w0.3bar check, 140bar)
E5 E6 E7 E8	CB2E-T11A-LHN CB2E-T11A-LIN CB2E-T11A-LAN CB2E-T11A-LBN	Restrictive counterbalance valve (3:1, 15 l/min, 0.17 kg)		70-280 bar (w1.7bar check, 210bar) 25-105 bar (w1.7bar check, 70bar) 70-280 bar (w0.3bar check, 210bar) 25-105 bar (w0.3bar check, 70bar)
F1 F2 F3 F4	CB2F-T11A-LJN CB2F-T11A-LKN CB2F-T11A-LCN CB2F-T11A-LDN	Restrictive counterbalance valve (4.5:1, 15 l/min, 0.17 kg)		140-350 bar (w1.7bar check, 210bar) 70-175 bar (w1.7bar check, 140bar) 140-350 bar (w0.3bar check, 210bar) 70-175 bar (w0.3bar check, 140bar)
G1	LO2A-T11A-XDN	Vent to open logic element, pilot source from port 1 (80 l/min, 0.12 kg)		3.5 bar
G2	LO2B-T11A-XDN	Vent to open logic element, pilot source from port 2 (80 l/min, 0.12 kg)		3.5 bar

\*Z is not marked on the body

